

TL48 non-conveyor w/- A7z Multihead

Thank you very much for your interest in a Aristo Digital Flatbed cutting/routing system! Below we have prepared the follow machine overview based on the initial size and materials your company will successful process time and time again.

When arriving to the point of providing a quotation, you will recieve a complete Aristo flatbed cutting system that covers all aspects of the machine, including hardware and software components, installation/training, warranty, tools, blades, and more.

Each process can require combinations of tools and may also include the need for additional tool systems to be evaluated. We make sure we provide a ready-state mahchine that is modular with prepared systems that allows for adaptation and growth. It is our goal to make sure the configuration we collectively create, matches your cutting/routing needs that you have today and in years to come!



TL48 (1625) w/ Multihead A7z

Site / installation requirements:

Electrical requirements

2 separate dedicated connections for cutter and vacuum system necessary

Cutter/Tool Heads

3 phase 208 v 30 Amp

Vacuum system

3 phase 208 v 60 Amp Specifications for each table:

Overall space requirements

TL48 - 14' x 24'

Compressed air requirements

115psi, 5cfm, moisture and oil free

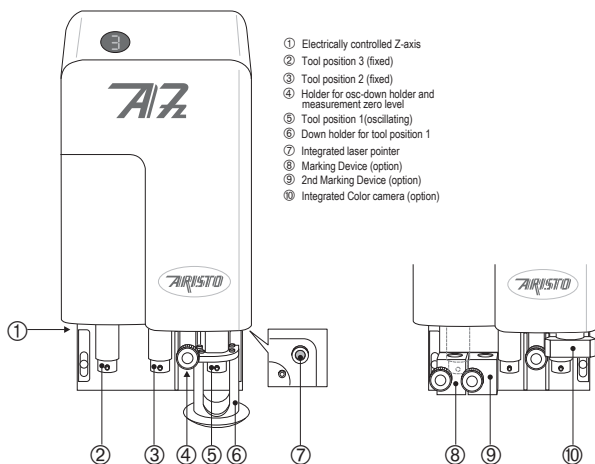
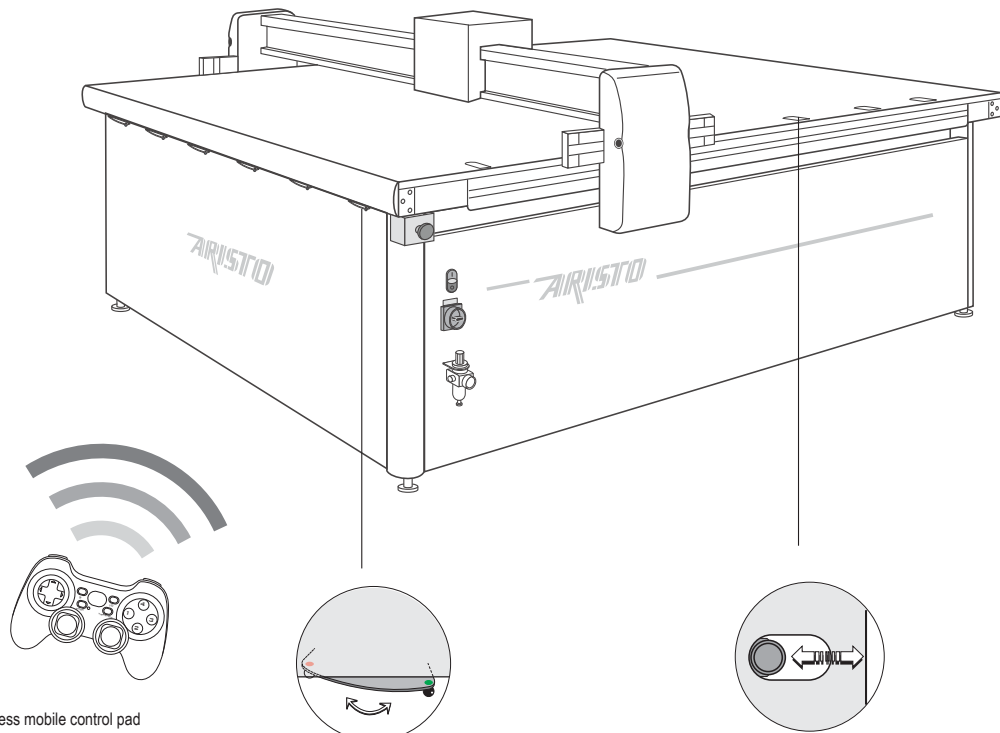

TL48 conveyor w/- A7z Multihead

Thank you very much for your interest in a Aristo Digital Flatbed cutting/routing system! Below we have prepared the follow machine overview based on the initial size and materials your company will successful process time and time again.

When arriving to the point of providing a quotation, you will recieve a complete Aristo flatbed cutting system that covers all aspects of the machine, including hardware and software components, installation/training, warranty, tools, blades, and more.

Each process can require combinations of tools and may also include the need for additional tool systems to be evaluated. We make sure we provide a ready-state mahchine that is modular with prepared systems that allows for adaptation and growth. It is our goal to make sure the configuration we collectively create, matches your cutting/routing needs that you have today and in years to come!



TL48 (1625) Conveyor w/ Multihead A7z

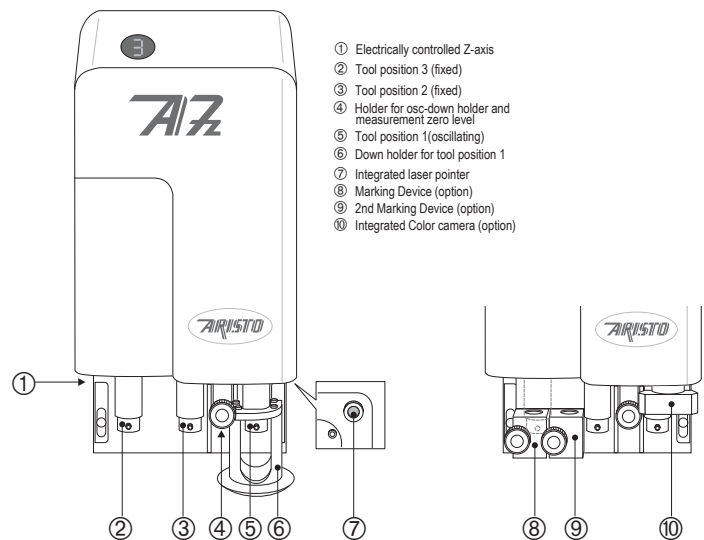
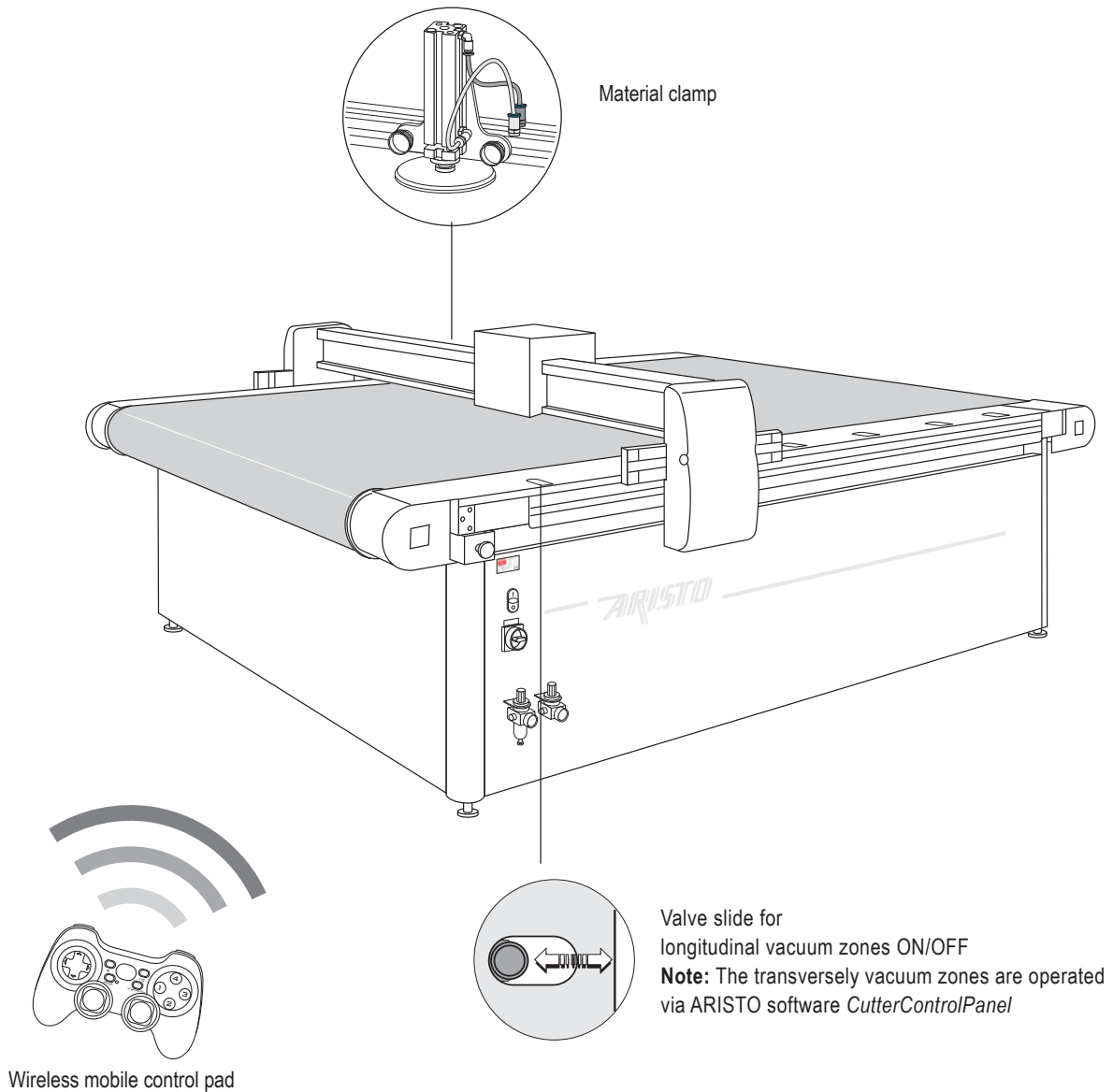

Site / installation requirements:

Electrical requirements

2 separate dedicated connections for cutter and vacuum system necessary

Cutter/Tool Heads

3 phase 208 v 30 Amp

Vacuum system

3 phase 208 v 60 Amp Specifications for each table:

Overall space requirements

TL48 - 14' x 24'

Compressed air requirements

115psi, 5cfm, moisture and oil free

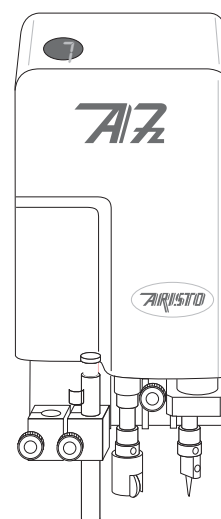
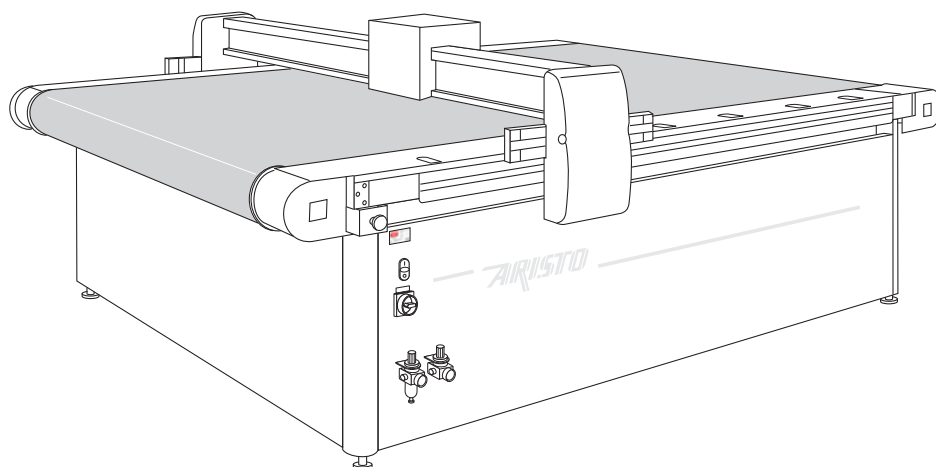

ARISTOMAT TL - High Speed Cutter of the new Generation

Clear designed cutting table

Impresses with its functional design and concentration on the basic essentials: a from all sides freely accessible work surface, extremely robust traverse bridge with minimal protruding at the sides and belt drive in all axis for slip-free drive. Powerful AC-servomotors and the modern CAN-Bus-steering technique enable the high throughput

Powerful vacuum technique

Up to 54 controllable vacuum zones hold even the smallest of remnants safely on the work surface.

Simple operating

With the easy-to-use operable *CutterControlPanel* software, available in many languages, the ARISTOMAT cutters are controlled from PC. The windows user interface offers the user all graphical informations of the cutting data. With the mobile control pad essential functions such as navigation or setting the origin allow an effective operation.

Various tool heads

Combinable single and multi-functional tool heads with tangentially controlled tool holders and a large number of precision tools, offer the possibility of a varied choice of materials to process. This variety of possibilities for material processing can be supplemented with the automatic measuring system *AutomaticEye* and the providing of data via mobile barcode reader.

Material transport

To automate the processing, the machines can be supplemented with a revolving conveyor, a powered unwinding device for continual material transportation of roll materials and a sheet feeder system - for automatic loading of sheet materials from a stack. The machines also can be converted to *ProductionLineCutters* (PLC) with integrated loading and/or unloading table.





Specifications ARISTOMAT TL

ARISTOMAT	Travels ¹⁾ (WxL) mm (inch)	Outer dimensions ²⁾ (WxLxH) mm (inch)	Speed ³⁾ adjustable via software	Acceleration ³⁾
TL 1310	1300 x 1000 (51 x 40)	1920 x 1760 x 1140 (76 x 69 x 45)	max. 1.13 m/s (45 in/sec)	max. 1.15 G
TL 1310C	1220 x 1000 (48 x 40)	1920 x 2140 x 1140 (76 x 84 x 45)	max. 1.13 m/s (45 in/sec)	max. 1.15 G
TL 1617	1600 x 1700 (63 x 67)	2220 x 2420 x 1140 (87 x 95 x 45)	max. 1.13 m/s (45 in/sec)	max. 1.15 G
TL 1617C	1520 x 1700 (60 x 67)	2220 x 2800 x 1140 (87 x 110 x 45)	max. 1.13 m/s (45 in/sec)	max. 1.15 G
TL 1625	1600 x 2500 (63 x 100)	2220 x 3220 x 1140 (87 x 127 x 45)	max. 1.13 m/s (45 in/sec)	max. 1.15 G
TL 1625C	1520 x 2500 (60 x 100)	2220 x 3600 x 1140 (87 x 142 x 45)	max. 1.13 m/s (45 in/sec)	max. 1.15 G
Material clearance thickness	max. 46 mm (max. 1.8 in) depending on the tool head and protective underlay			
Input buffer	PC controlled			
Static repeatability	± 0.02 mm/m (0.008 in) @20 degrees centigrade			
Control circuit and drives	Digital AC servo motors			
Data format	HPGL compatible, with extended command set			
Vacuum	Adjustable matrix vacuum zones			
Power supply³⁾	3-phase fixed connection, 400V, 50Hz			
Operating	ARISTO control software for Windows XP, Vista (32 bit), 7 (32 bit / 64 bit) Various selectable languages. Mobile control pad.			
Ambient conditions				
operating temperatur	+10°C up to +30°C 50°F up to 86°F			
storage temperatur	-15°C up to +45°C 5°F up to 113°F			
rel. humidity	40 - 80% non-condensing			
Safety / Certification	CE-label; Emergency stop; Light barrier; Collision shut-off			

- 1) Complies to the max. work area for one tool. Further tools reduce the max. work width.
 1) The dimensions only refer to the basic machine.
 2) Depending on the cutter size, cutter configuration and tool head.

Options

- ✓ Conveyor system with integrated uploading table (PCL-Machine)
- ✓ Motorized and manually winding and unwinding devices for roll materials
- ✓ Material clamp system
- ✓ *SheetFeeder* for automatic loading of sheet materials, also in combination with a motorized unwinding device
- ✓ Various combinable tool heads
- ✓ Data base *CutRecall* for saving, calling and editing of all process parameters
- ✓ Intelligent camera system *AutomaticEye* for accurate assignment and scaling of prints
- ✓ Mobile *BarcodeReader* for automatic process identification
- ✓ Projection of the cutting outline onto the material



ARISTO Graphic Systeme GmbH & Co. KG • Schnackenburgallee 117 • D - 22525 Hamburg/Germany • Phone: +49 40 547 47 0 • Fax: +49 40 547 47 111 • www.aristo.de
 ARISTO GRAPHIC SYSTEME Ges.m.b.H. • Jakob Prandtauer Straße 1 • A - 6300 Wörgl/Austria • Phone: +43 53 32 76 22 9 0 • Fax: +43 53 32 76 22 9 77 • www.aristographic.at
 INTEGRAL TECHNOLOGIE SARL • 8/10 rue du Bois Sauvage Bât i • F - 91055 Evry Cedex/France • Phone: +33 1 64 97 81 82 • Fax: +33 1 64 97 81 66 • www.aristo.fr

ARISTO
Cutting Solutions

Why Aristo Digital Cutting Solutions



History in precision tooling and leader in cutting

Aristo cutting systems are not only the product over 152 years of precision tooling and engineering but also of the focus Aristo continued development, workmanship, and dedication to providing a leading cutting solution for worldwide vertical markets in cutting and precision finishing needs in over 45 countries.

German quality, precision and reliability.

Feel confident that your Aristo cutters is designed for 24/7 operation and use in mind. The combination of robust construction and superb accuracy proves time and time again this is a cutter high production output.



Versatility and longevity.

Growth and broad material processing is delivered by the Aristo cutters and leading MultiHead Tool for the market. The Aristo can process materials over 1.5" thick and with the MultiHead you can cut, crease, oscillate without a single manual head or tool change. And with years of use in mind Aristo has proven that the Multihead solution can deliver as they continue to run the dedicated testing on a Toolhead that has been running 24/7 for over 2 years without interruption.

Installation, Service, Support security for you

Aristo works closely with Rock Hill Distribution in North American to support customers and resellers with sales, support and service objectives that are vital to their success. With demonstrations facilities, parts warehouse, and technicians that are able to be dispatched around the country immediately, we are confident that we are well equipped to assist you in all your Aristo needs.



Worldwide distribution and service.

Aristo has a well versed and dedicated network of distributors and service partners that value providing exceptional before, during, and after sales support service that can be dispatched quickly to their entire customer base with technicians located around the world and more importantly around the US. All service technicians located in more than 45 countries, are trained and certified at the factory in Hamburg, Germany. Service and support contacts, along with interactive virtual support provides top customer support and operation uptime so that your production and processing is not interrupted.